

J. IRIZAR & COMPANY LTD

3123 – 43 Ave Edmonton, Alberta T6T 1C7 Canada

Phone & Fax: 1 – 780 - 450 6695

E mail: jirizar@jirizar.com Website: <http://www.jirizar.com>

Irizar Magnetic Fillet Guide Kit (For Lincoln LT7 Tractor)

This is an add-on accessory for Lincoln's LT7 Tractor (K227-1) or similar welding tractors for outside diameter fillet welds. It is applicable for storage tank with diameter larger than 4800mm and base plate flange extension over 100 mm (4"). The kit consists of (3) components:

- a. Permanent Magnet Guide (Fig.1)
- b. Front lateral wheel set (Fig 2 & Fig.3)
- c. Rear lateral wheel (Fig. 4)



Fig.1



Fig.2



Fig.3



Fig.4

J. IRIZAR & COMPANY LTD

3123 – 43 Ave Edmonton, Alberta T6T 1C7 Canada

Phone & Fax: 1 – 780 - 450 6695

E mail: jirizar@jirizar.com Website: <http://www.jirizar.com>

ASSEMBLY & INSTALLATION

1. Drill four holes on the Tractor at the mounting plate indicated in fig. 5 according to the dimensions shown in fig. 6.

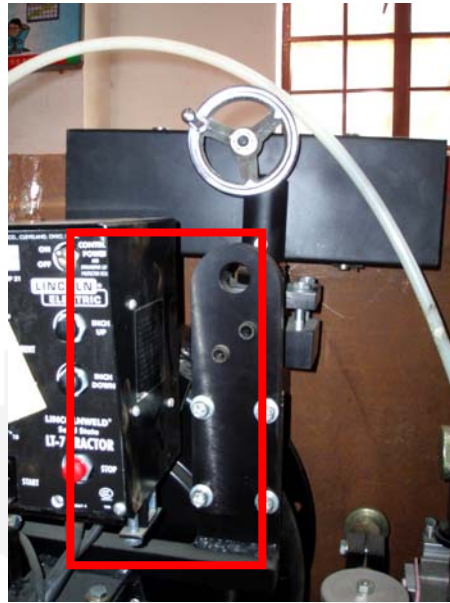
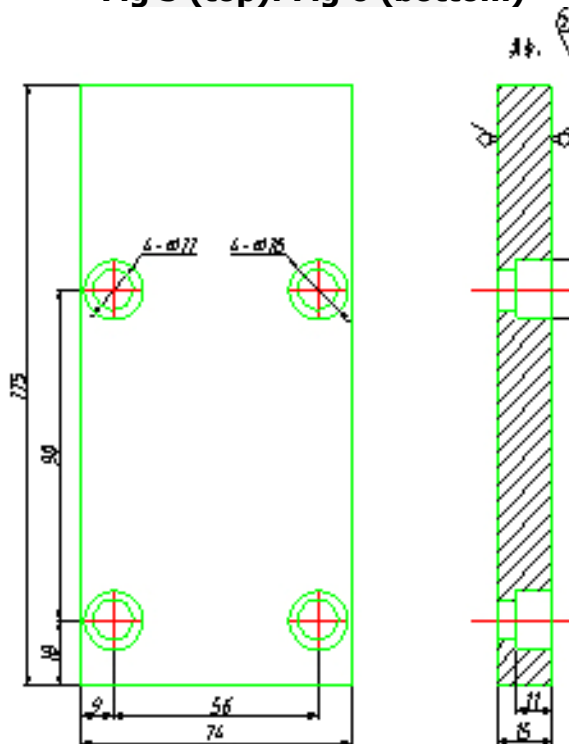

Fig 5 (top): Fig 6 (bottom)



J. IRIZAR & COMPANY LTD

3123 – 43 Ave Edmonton, Alberta T6T 1C7 Canada

Phone & Fax: 1 – 780 - 450 6695

E mail: jirizar@jirizar.com Website: <http://www.jirizar.com>

2. Use head bolts and nuts to fasten **Magnetic Guide** on the LT7 mounting plate as indicated in fig 7 and fig 8.



Fig. 7



Fig. 8

3. Mount **Front Lateral Wheel Assembly** (Fig. 9) directly on the clamp arm and steering assembly of the LT7 tractor, which allows the operator to adjust the distance between the tractor and the shell with driving wheel (Fig.10) and provides a mean of tracking when the tractor is propelling along the tank O.D. Fig 11 illustrates a Lincoln LT7 tractor with front lateral wheel assembly readily installed.



Fig 9

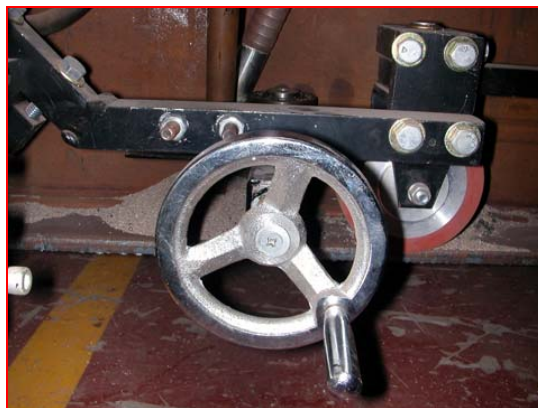

Fig. 10

J. IRIZAR & COMPANY LTD

3123 – 43 Ave Edmonton, Alberta T6T 1C7 Canada

Phone & Fax: 1 – 780 - 450 6695

E mail: jirizar@jirizar.com Website: <http://www.jirizar.com>

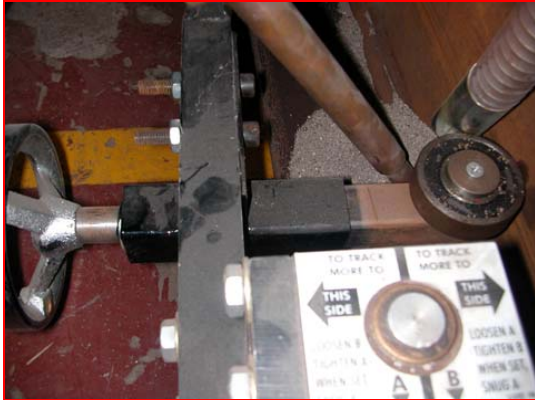

Fig. 11



Fig. 12

4. Mount the **Rear Lateral Wheel** (Fig. 12) on the axle of LT7's rear wheels shown in Fig. 13 provide the necessary rear support of the tractor when traveling along the tank O.D.



Fig. 13